

THE BEACON

C L E V E L A N D

⌘ A STARK ENTERPRISES AND DESSLER JOINT VENTURE

PROFESSIONALLY MANAGED BY
STARKLIVING
⌘ A STARK ENTERPRISES COMPANY

BE GUIDED HOME

BE FULFILLED

BE ACCOMMODATED

BE CAPTIVATED

BE IN THE CENTER

BE SELECTIVE

BE WELCOMED

BE FIT

BE SOCIAL

BE CONNECTED

BE A GUEST

BE A GOOD
COMPANION

BE ENERGIZED

BE SECURED

THE BEACON
C L E V E L A N D

⌘ A STARK ENTERPRISES AND DESSLER JOINT VENTURE



BE GUIDED HOME

Discover a new standard of living at The Beacon, downtown Cleveland's most premier community. Centrally located in the heart of the Central Business District, The Beacon is conveniently situated to allow you to be fully integrated with all that Cleveland has to offer. The Beacon offers a multi-dimensional living experience transporting you from city entertainment and dining to rest and relaxation of your home by simply stepping through our front door.



BE FULFILLED

Everyone is unique with their own style, so choosing a floor plan that meets your needs and fits your lifestyle is important. With over 187 suites to choose from, The Beacon offers Blonde and Gray color schemes with clean, comfortable layouts, so your space functions properly for all your daily activities.

BE ACCOMMODATED

The Beacon, located in the heart of the city, is always here to welcome you home or comfortably send you off to take on the day.



BE CAPTIVATED

Offering a view like no other, our Sky Deck showcases Cleveland from a perspective you've never seen before. From the Annual Air Show on Labor Day to the Festive Holiday Lights in December and all the days in between, experience it for the first time from our point of view.





BE IN THE CENTER

Enjoy the convenience of local grocery stores to fill up your home kitchen as well as nationally acclaimed restaurants on the exciting East 4th street, all within walking distance. Whichever your cooking style or favorite meal, there are many nearby options to fuel your days and ease your evenings.



NORTH
VIEW



EAST
VIEW



SOUTH
VIEW



WEST
VIEW

BE SELECTIVE

Take time to ensure your space accommodates your life's uniqueness. With several styles to choose from, The Beacon provides adaptable layouts for all preferences with picturesque views for the ideal style of living.

ROOFTOP
SKY LOUNGE
SKY DECK
DOG PARK
Level 29

Levels
23-28

TERRACES
Level 22

Levels
9-21

THE BEACON BACKYARD
& POOL AREA
Level 8

THE BEACON'S
FRONT FACADE
FACES SOUTH

FITNESS CENTER
MAIL & PACKAGE ROOM
PERKS STATION
Level -2

TERRACE FLOOR PLANS

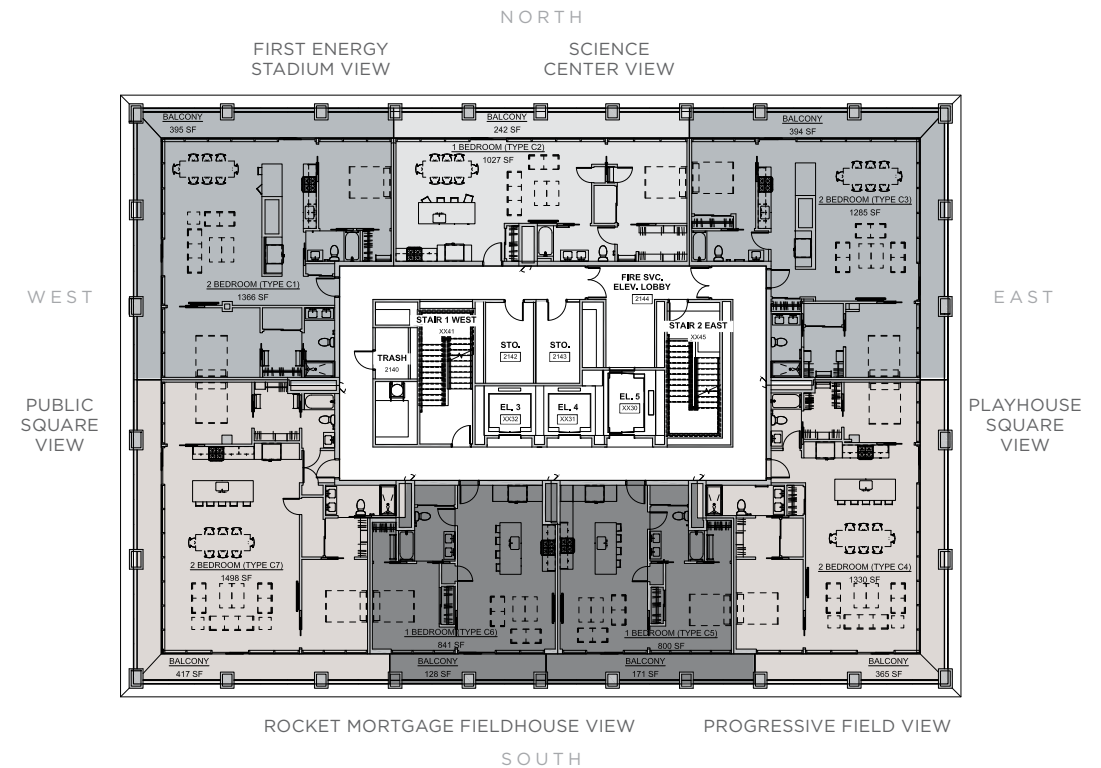

FLOOR PLANS

NORTH

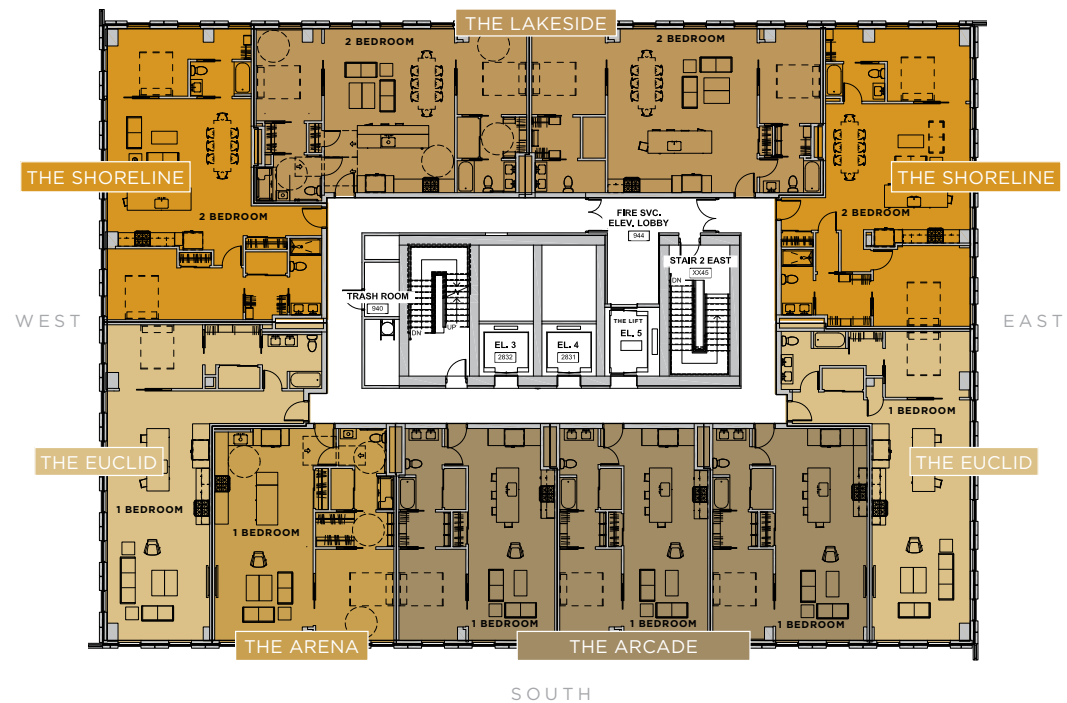

SOUTH



THE ARENA
ONE BEDROOM
ONE BATHROOM



THE ARCADE
ONE BEDROOM
ONE BATHROOM



THE EUCLID
ONE BEDROOM • ONE BATHROOM



THE SHORELINE
TWO BEDROOM • TWO BATHROOM

THE LAKESIDE
TWO BEDROOM
TWO BATHROOM





BE WELCOMED

Our experienced management team is always happy to assist you with everything from food and mail delivery, to guest access. Our team will ensure you are well taken care of whether you are home or away.

PROPERTY AMENITIES

Beacon Backyard: Pool Deck, Grilling Area, Fire pits & Lounge
Bike Vault
Building-wide Cable and Internet
Cable and Internet Ready with Private Wi-Fi Network
Coffee Bar
Dog Spa
EV Charging Stations
Guest Suite
Local Transit System
LuxerOne Package Delivery System
On-site Restaurants
Rooftop Dog Park
Rooftop Panoramic Sky Deck with Fire pits & Outdoor Lounge
Rooftop Sky Lounge with full service kitchen
State-of-the-art Fitness Center with Cardio Machines, Weight Bench and Strength Training Area
Wellness Studio (Yoga, Spin) with Wellbeats On-Demand
Walkable Downtown District

RESIDENT SERVICES

Beacon Blackcard - Neighborhood Discount Program
Business Services
Monthly Calendar of Social & Community Events
Monthly Newsletter
Resident Services Concierge
Resident Online Portal
Referral Program
Secure Mail Room
Weekly Grab & Go Breakfast

UNIT FEATURES

Intimate Floors with 7-10 apartments per floor
Custom Room-Darkening Window Coverings
Ecobee Smart Thermostat
Expansive Open Floor Plan with 9-10 foot Ceilings
Floor-to-Ceiling Windows
In-suite Washer and Dryer
Two Color Scheme Options: Blonde & Grey
Unparalleled Views of Downtown & Lake Erie
Walk-in Closet(s) with Shelving

ACCESSIBILITY

Controlled Access
Video Patrol
Schlage Smart Lock System
After-Hours Security Coverage
Emergency Maintenance Services
On-Site Dry Cleaning Drop Off
Integrated Garage Parking

PROPERTY DETAILS

Built in 2019
187 units/29 Stories
515 Euclid Ave. Cleveland, OH 44114

PET FRIENDLY

Cats and Dogs Permitted
Up to 75 pounds Combined Weight • 2 Pet Limits

*IN SELECT UNITS



KITCHEN

High-end Contemporary Finishes
Oversized Island with Seating
Modern Custom Cabinetry with Ample Storage
Quartz Counter tops
Stainless Steel, Smart Appliances
Waterfall Island Counters*

BATHROOM

Illuminated Mirrors*
Floating Vanities with Storage
Glass Shower Enclosures
Duel Access from Bedroom & Living Space
Private Bathroom for Primary Bedroom*



BE FIT

Continue to take part in all the activities you enjoy and make staying healthy in the heart of the city something to look forward to with our 24/7 state-of-the-art fitness center, private dog park and community fitness events.

WELLNESS CENTER

Ab Crunch Bench
Cross Trainer
Cable Combo Machine
Cable Machine
Exercise Balls
Free Weights
HD Television
Heavy Bag
Lat Pull Down
Leg Curl/Extension
Leg Press
Leg Raise
Medicine Balls
Recumbent Bike
Resistance Cables
Strength Training Area
Treadmills
Upright Bike
Weight Bench
Wellbeats™ On Demand
Wellness Studio
Yoga Mats



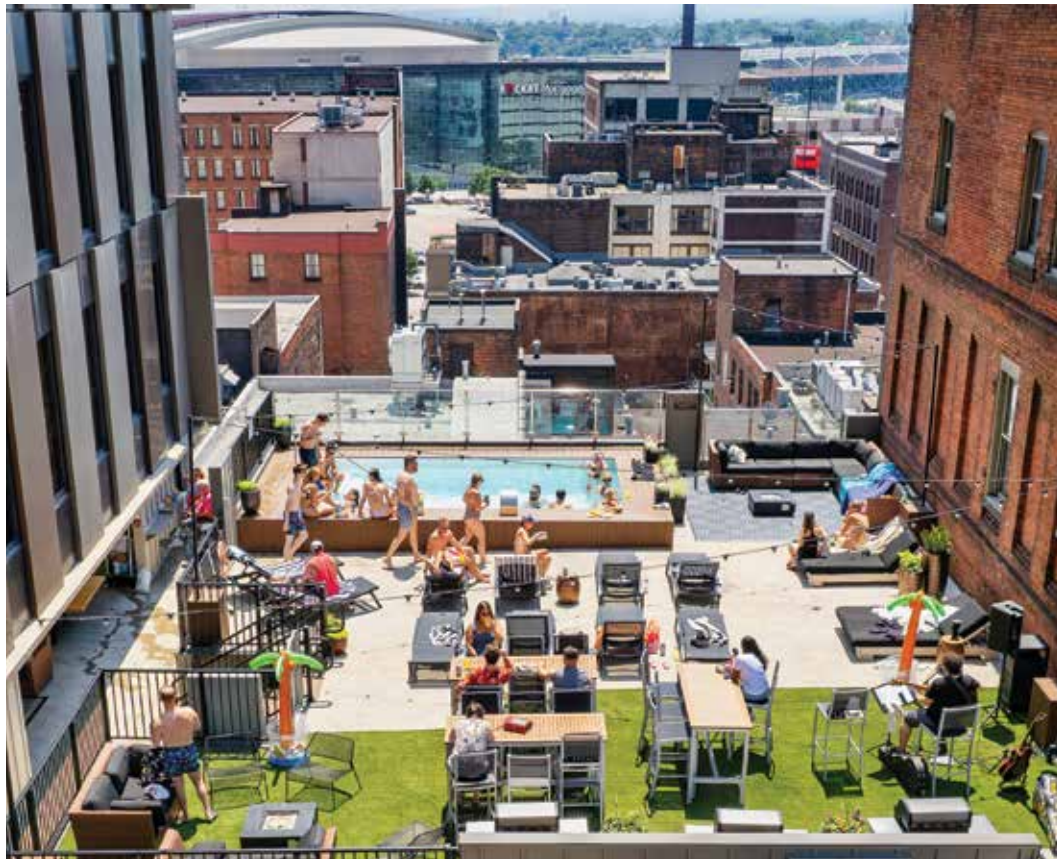

BE SOCIAL

Imagine a weekend morning in your perfect retreat to take in the sun poolside, or a warm afternoon to grill your favorite foods with friends and neighbors. After a day's work the Beacon Backyard is the place to relax on a cozy daybed or sit by the fire and enjoy the night.

BE CONNECTED

The spacious social area, located on the 29th floor's thrilling rooftop Sky Lounge, provides the idyllic outlet for meetings, downtime and life's celebrations. With a full-service kitchen and plenty of space to host a wide variety of community events, gather with neighbors, work remotely, and stay connected.





BE A GUEST

Welcome your friends and family to a beautiful space for them to stay and relax. Elevate the visiting experience and host your loved ones in your very own guest suite with all the amenities and breathtaking views.

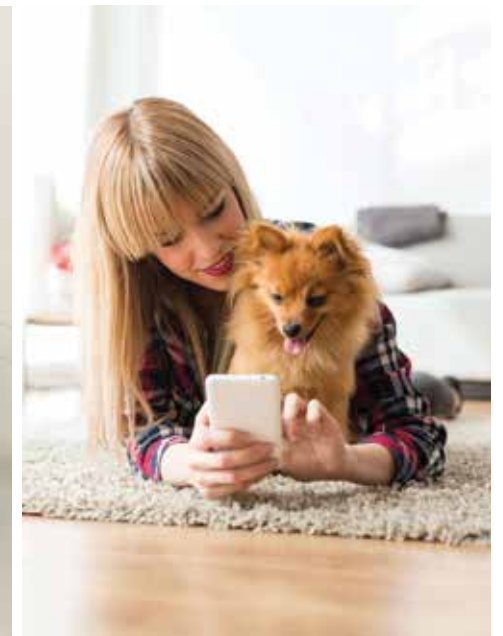

BE A GOOD COMPANION

The 29th floor rooftop dog park, accessible to all residents, provides your four-legged friend(s) room to roam, all in a private space amidst beautiful downtown views. The Dog Spa is available to pamper your pup and keep them looking and feeling fabulous. Rest assured that your faithful pooch can be bathed and groomed in a calm and safe environment.



BE ENERGIZED

Conveniently located charging stations make it easy to stay on the go. EV charging stations are readily available for residents in the fully integrated parking garage.



BE SECURED

Feel content knowing your bike is safe in our secure Bike Vault. With easy access and security, maintain your active, urban living lifestyle in a reliable and protected environment.

Lake Erie

DOWNTOWN



THE BEACON

C L E V E L A N D

⌘ A STARK ENTERPRISES AND DESSLER JOINT VENTURE

THE BEACON
515 EUCLID AVE
CLEVELAND, OH 44114

216.279.7470
BEACONCLE@STARKLIVING.COM
THEBEACONCLE.COM



STARKLIVING

⌘ A STARK ENTERPRISES COMPANY